



# A300 CAR DVR USER MANUAL

1080P  
FULLHD

150°  
WIDE ANGLE

G-Sensor

P  
PARKING MODE



ver. 1.0

## INTRODUCTION

Thank you for choosing CARFORCE video recorder. This product is used to record an image that is identical to what the driver sees when driving a car. By documenting the driving history, you can perform a detailed analysis of the traffic event recorded in the video. We believe that by offering the product to you, we will increase the road safety. NOTE! Images of third parties may appear on camera recordings. It is not permitted to publish these images e.g. on the Internet without the consent of these persons. In some countries, the use of driving recorders is prohibited under financial penalty. Before travelling abroad, check the regulations in the specific country.

## DEVICE SCHEME

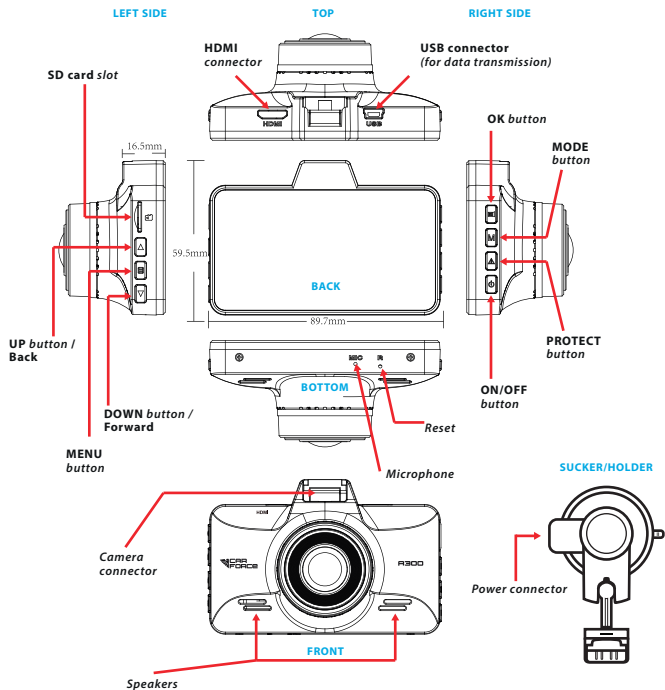

**UP:**

Navigation in menu and files. Photo Zoom. Sound adjustment.

**MENU:**

Going in and out from the setup menu.

**DOWN:**

Navigation in menu and files. Photo Zoom. Sound adjustment.

**OK:**

Used to approve in the menu and as a function key (rec / play / pause / shutter button).

**MODE:**

Operating mode switch: camcorder / camera / playback.

**PROTECT:**

Blocks the file from being overwritten or deleted.

**ON/OFF:**

On/Off switch.

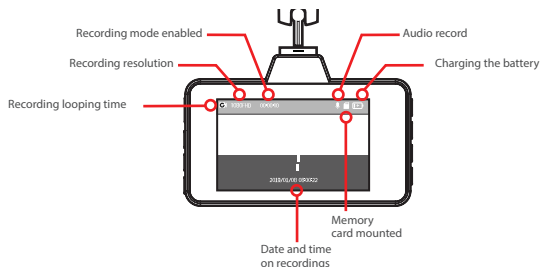

## 1 Turning recording On/Off:

The A300 dashboard camera will start recording immediately after installation and activation. In order to turn the recording off and on again, press the **OK** button. When the route recording is turned off, the time of recording mode will disappear from the screen.

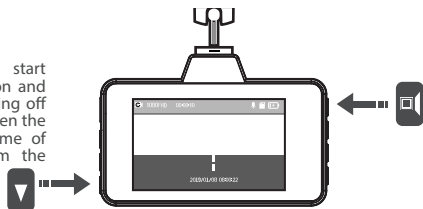

During the recording of the route, it is possible to turn the audio recording on / off using the **DOWN** button.

## 2 Taking a photo:

In order to take a video with the dashboard camera, turn off the recording mode by pressing the **OK** button (\*1) and press the **MODE** button (\*2). The camera icon and the set resolution will appear on the screen. The device can now take a picture by pressing the **OK** button (\*3). To return to recording again, press the **MODE** button (\*4) twice.

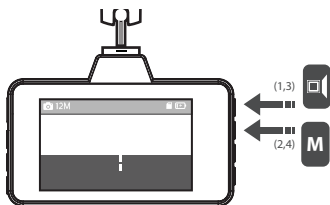

### 3 Protecting an event:

In order to protect the file, the video recorder must be set in recording mode. To protect the recording from overwriting, press the **PROTECT** button. While saving then file, a padlock icon will appear on the screen. The file will be saved to the memory card in a separate folder.

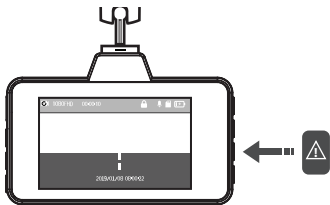

### 4 Browsing saved files:

To check the recorded files, turn off the recording mode by pressing **OK** (\*1) and press the **MODE** button (\*2) twice. The saved files will appear on the screen. Recorded videos and photos are browsed using the **DOWN** and **UP** buttons. To view and stop the video, press the **OK** button.

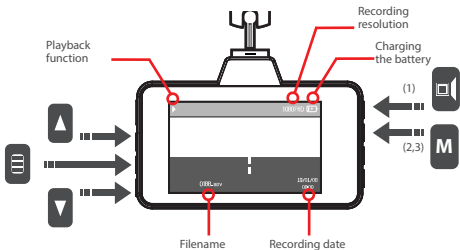

The video can be sped up using the **DOWN** button. Files protected from overwriting have a padlock icon. Saved files can also be protected or deleted by pressing the **MENU** button (**to delete a file previously protected against overwriting, it should be unblocked**). To return to recording, click the **MODE** button (\*3) once.

### 5 Turning off and sleep mode:

It's possible to turn off the display of the dashboard camera during recording by pressing the **ON/OFF** button once. To turn on the display, press the **ON/OFF** button again.

To turn off the device, keep pressing the **ON/OFF** button for approx. 2 s

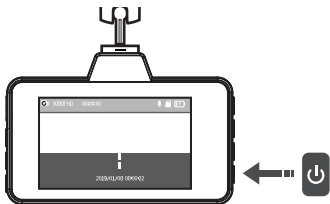

1

To launch the user menu, turn on the dashboard camera and click the side **MENU** button.

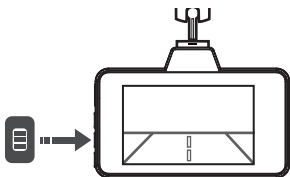

2

The menu can be navigated using the side **DOWN** and **UP** buttons.

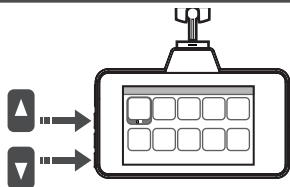

3

Using the **OK** button, we change the previously selected setting.

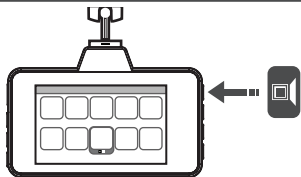

4

To accept changes and return to the menu and the main screen, it's necessary to click again on the side **MENU** button.

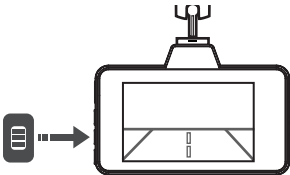

5

## SETUP MENU - FUNCTIONS

### Resolution:

1920 x 1080 FHD  
1280 x 720



### Looping the recording:

OFF  
1 minute  
3 minutes  
5 minutes



### Changing resolution of photos:

12M 4032X3024  
2 M 1920X1080  
5 M 2592X1944  
8M 3264X2448



### Selecting language of the panel



### Changing date and time



### Sensitivity of shock sensor

(determines the automatic saving of files to the protected form)



### Parking mode: on / off and sensitivity of the shock sensor in the parking mode



### Motion detection: on / off



### Record of the plate number on recordings



### Record of the date on the recording:

YES  
NO



### Audio recording:

ON  
OFF



### Sound signals:

ON  
OFF



### Screen blanking:

OFF  
after 1 minute  
after 3 minutes  
after 5 minutes



### Automatic shutdown:

OFF  
after 1 minute  
after 3 minutes  
after 5 minutes



### Frequency:

60 Hz  
50 Hz



### Format of the memory card



### Restoring factory defaults



### Software version information





**CAR  
FORCE**